

# Day to Day Power Beam

Step 1: Remove one screw from leg assembly.

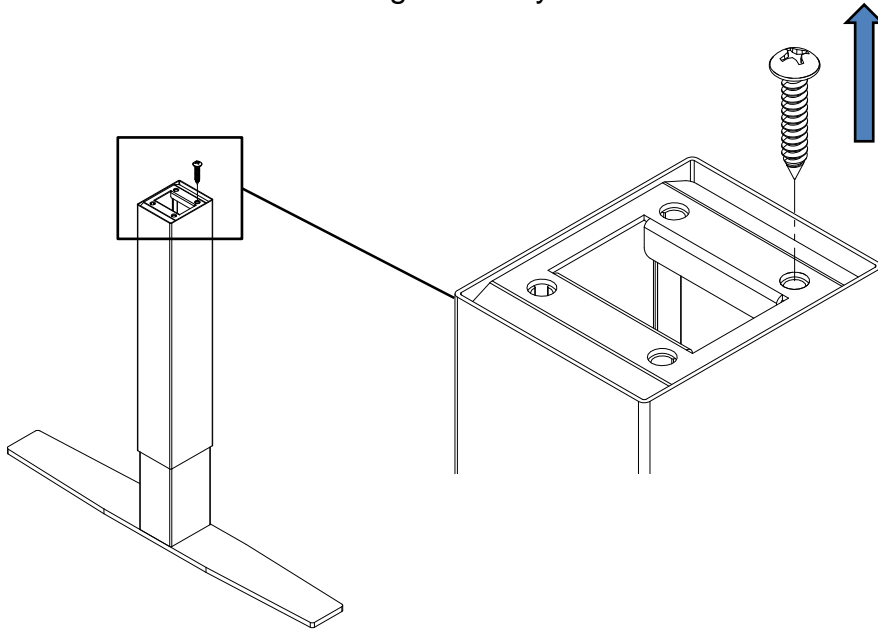

Step 2a: Slide Vertical into Beam Base, align holes and use (4) #10 x 1" pan head sheet metal screws to secure each leg. (End leg shown. See step 2b for shared leg configuration)

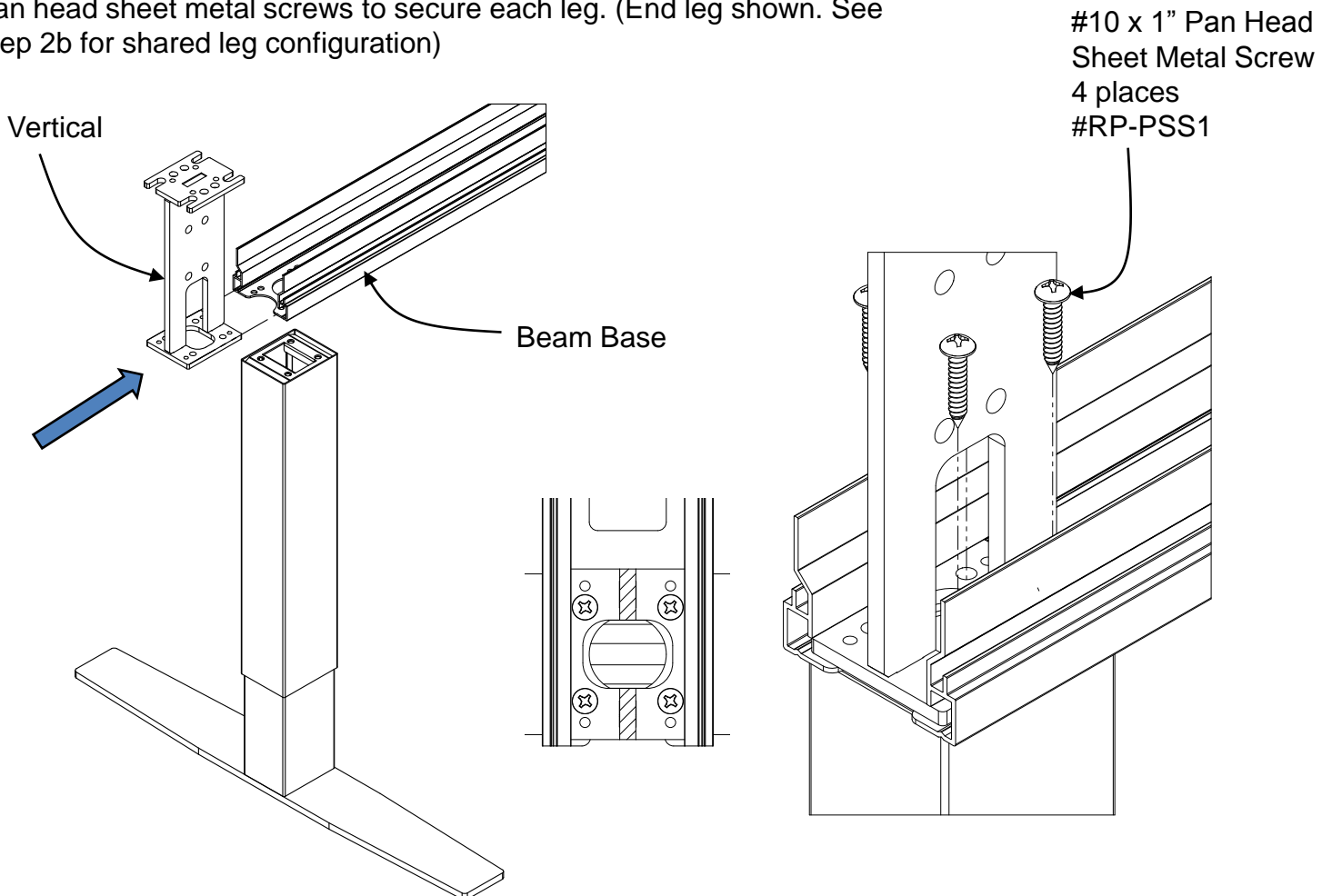

# Day to Day Power Beam

Step 2b: Slide Vertical into Beam Base, align holes and use (4) #10 x 1" pan head sheet metal screws to secure each leg.

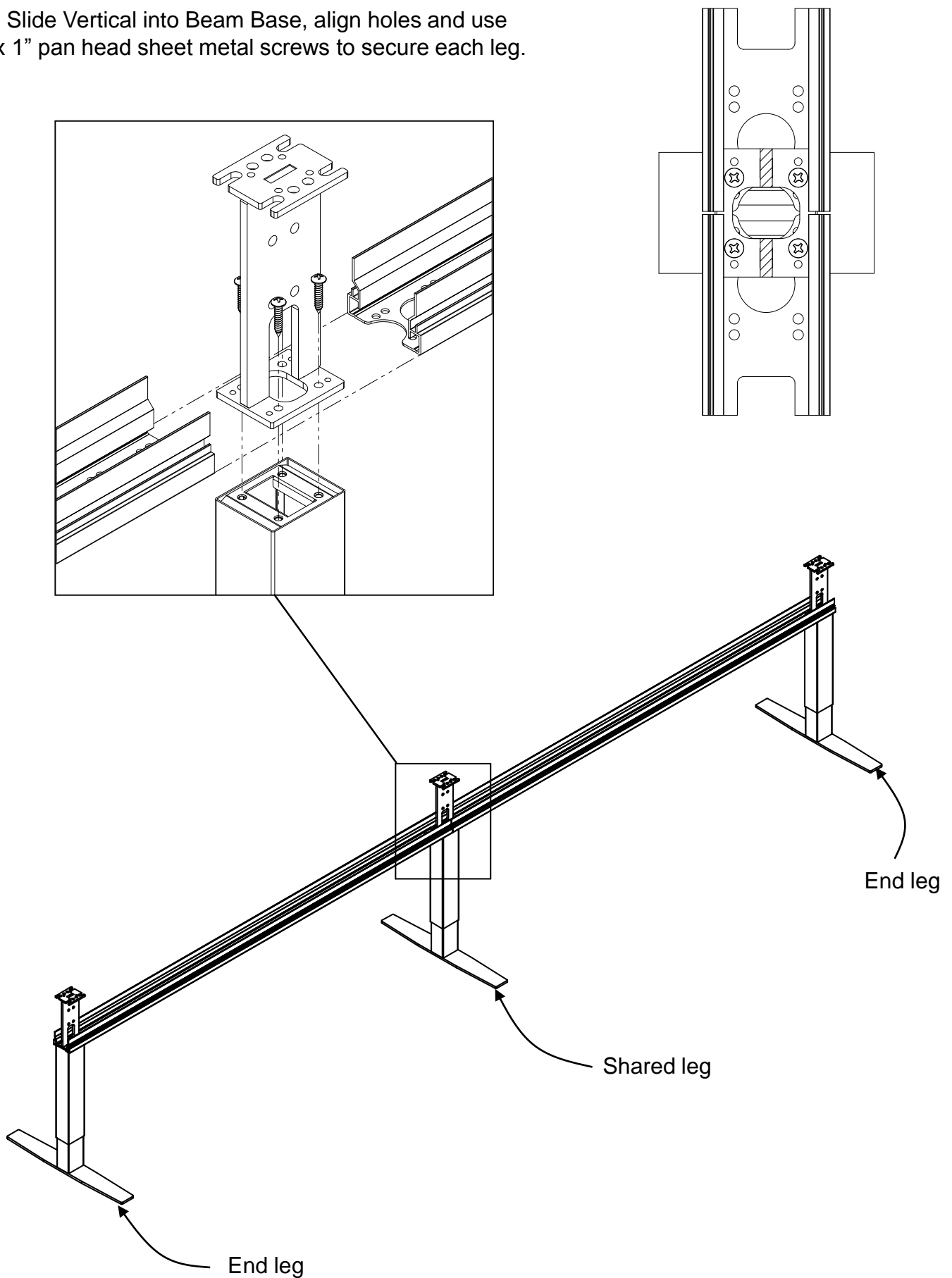

# Day to Day Power Beam

**Step 3:** Install Beam Top Assembly using Twist Plates and 1/4-20 x 5/8" Cap Screws

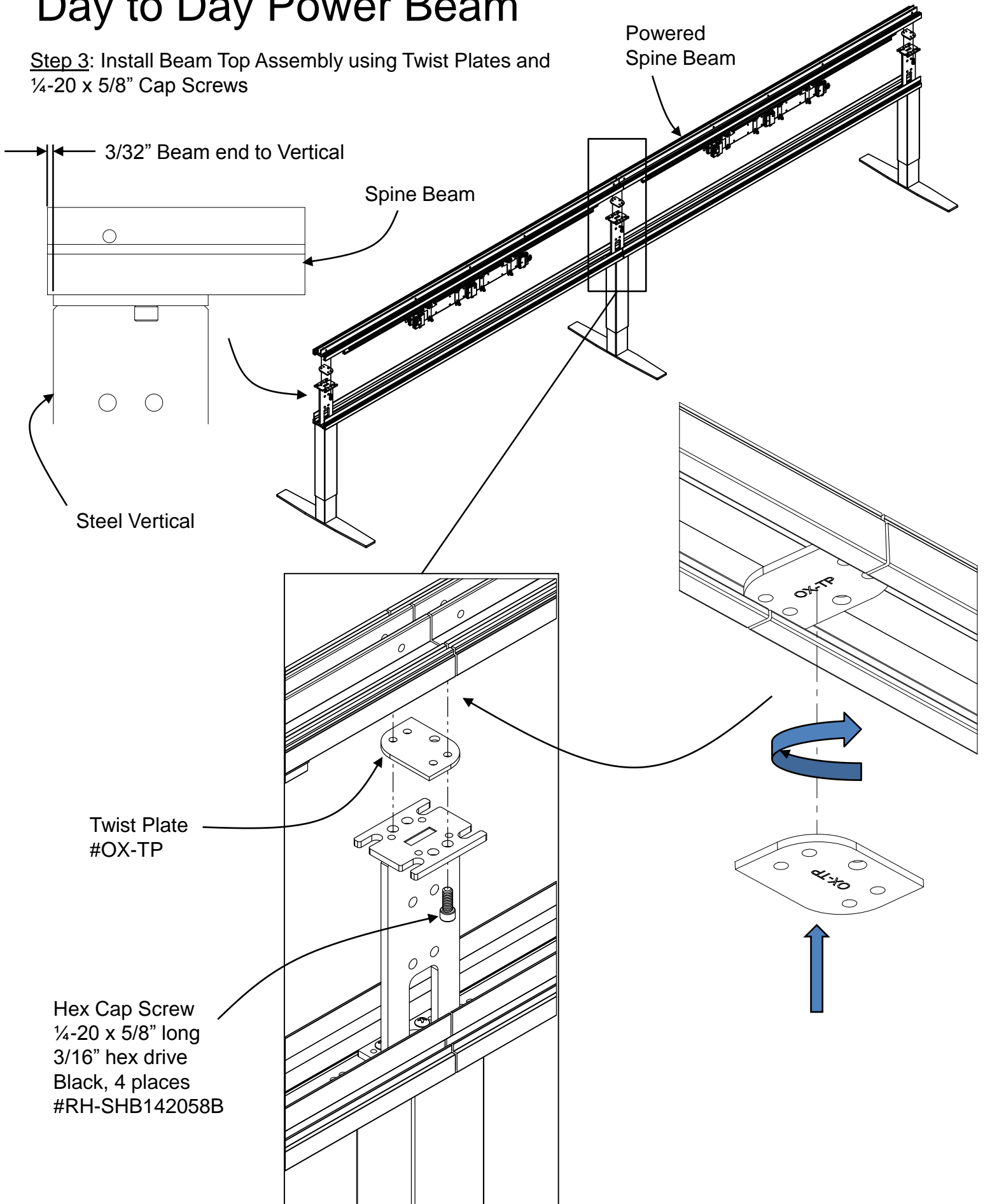

# Day to Day Power Beam

Step 4: Install Outlets to Beam using (1) 10-24 x 5/8" Pan Head Thread Cutting Screw

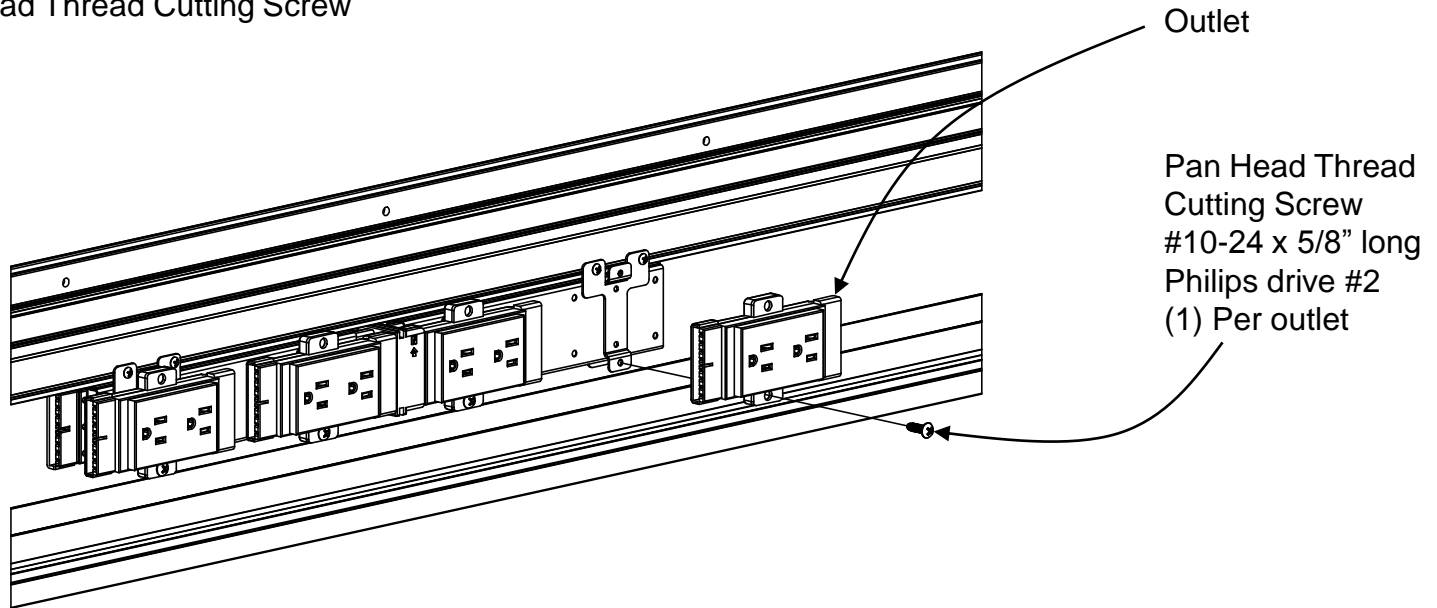

Step 5: Plug Jumpers into powerway, making sure to fully engage locking clip!

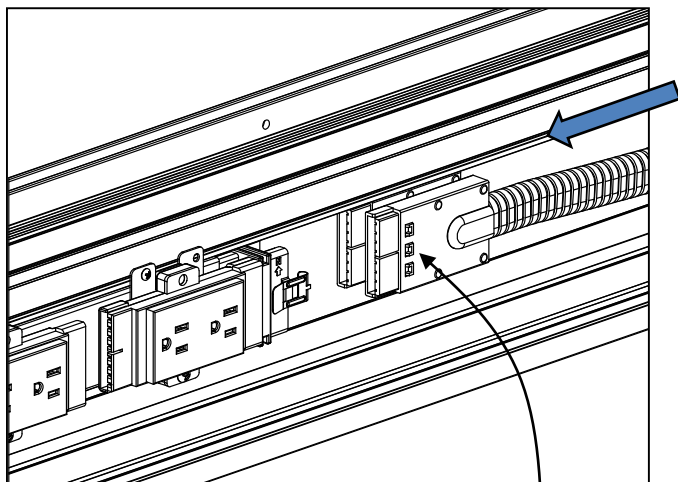

Engage clip **HERE**

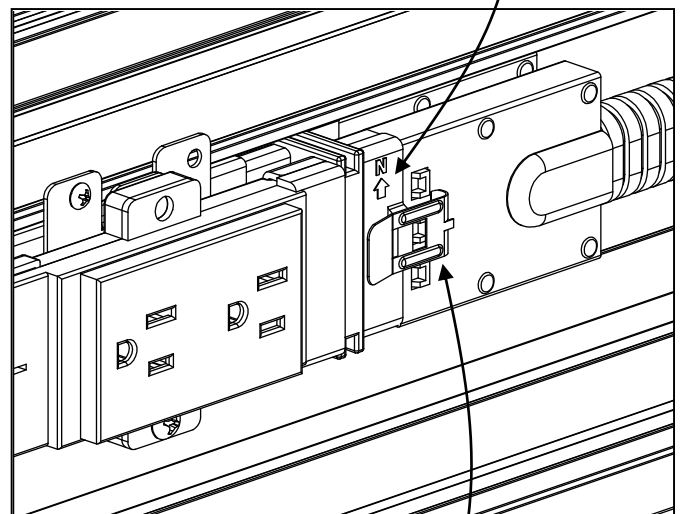

Fully Engage Locking clip



# Day to Day Power Beam

## Step 6: Install Base Feed.

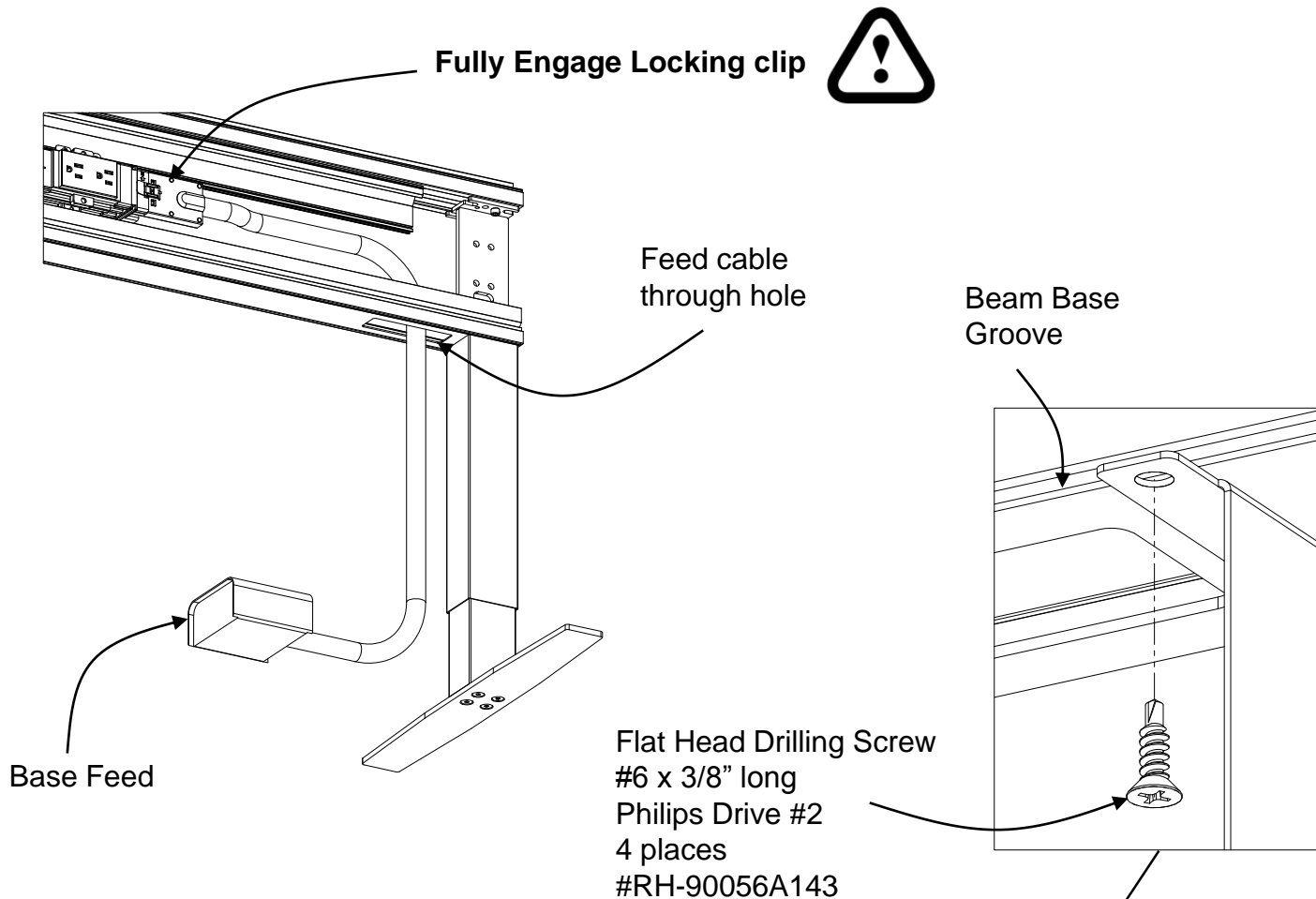

## Step 7a: Install Vertical Wire Manager Shell.

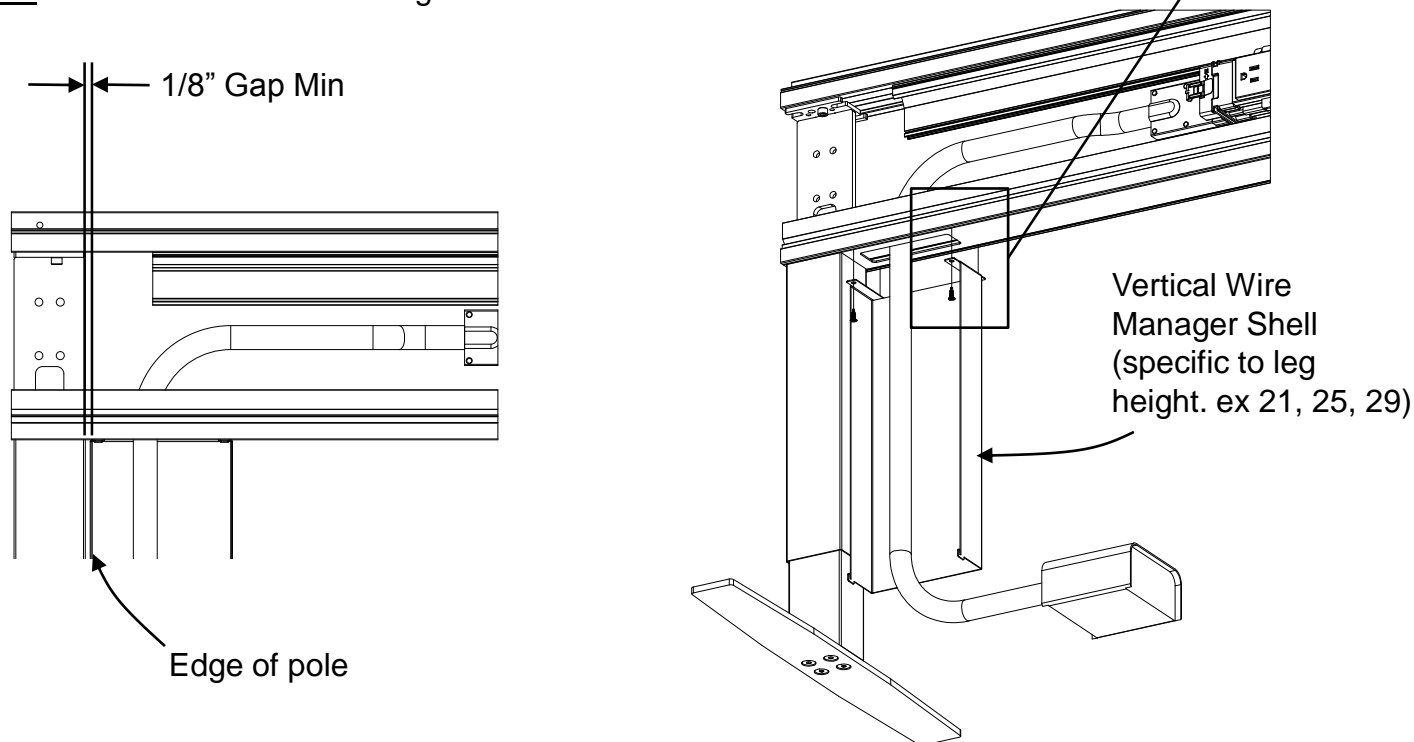

# Day to Day Power Beam

Step 7b: Install (2) Vertical Wire Manager Base Shroud.

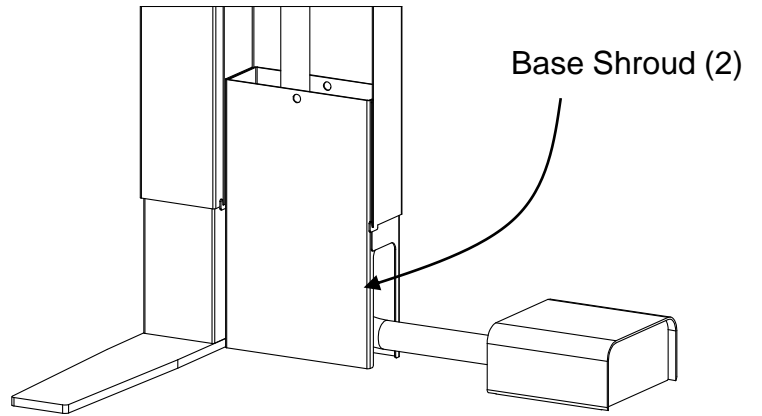
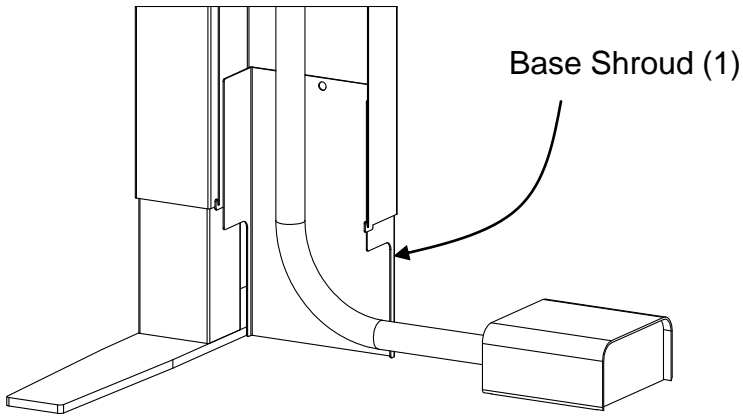

Step 7c: Install (2) Vertical Wire Manager Cover.

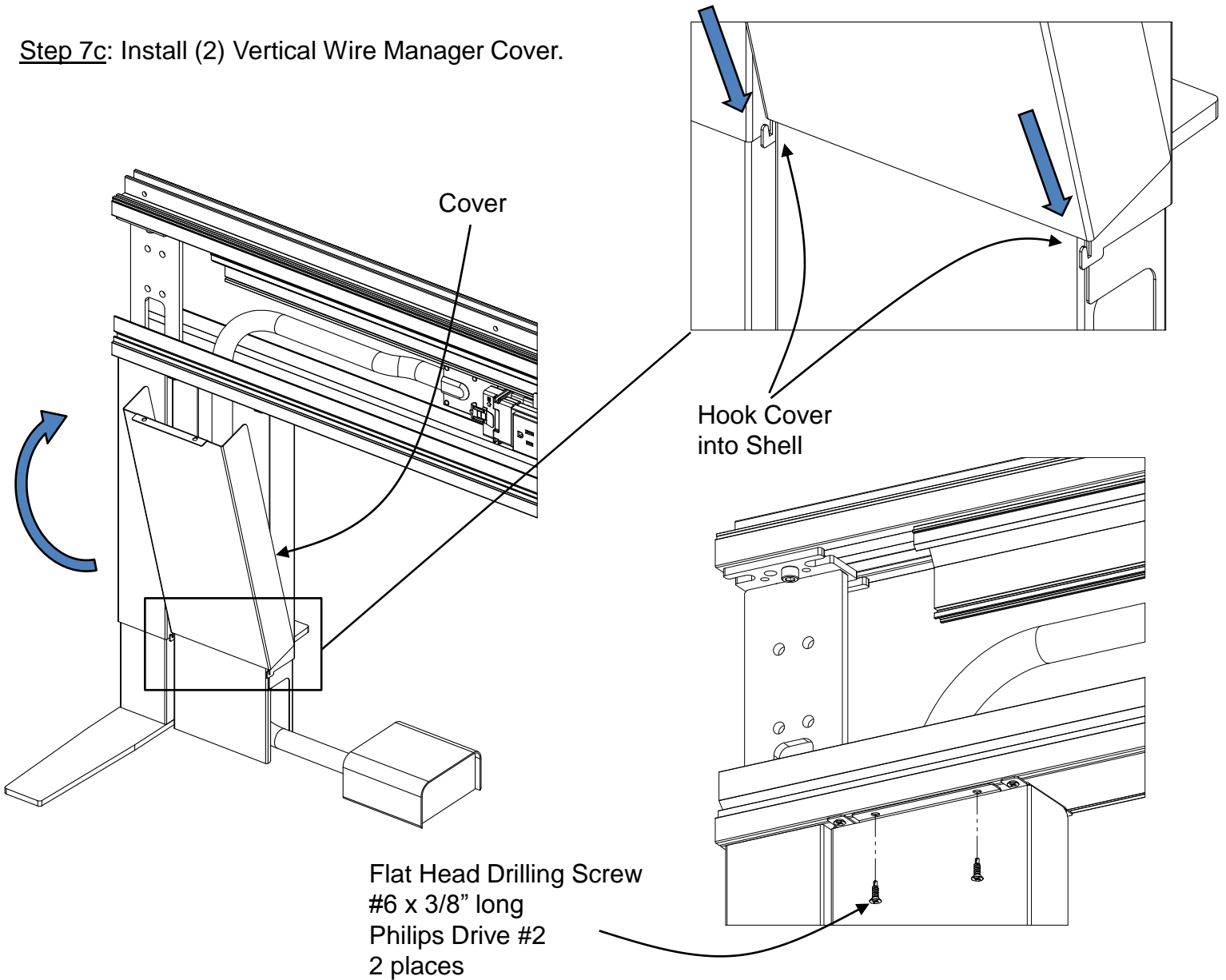

# Day to Day Power Beam

Step 8: Install End Caps. DO NOT over torque.



1/4-20 Flange Nut  
7/16" External Hex Drive  
2 places  
#RH-95479A111  
**LOW TORQUE**

Washer  
2 places  
#RP-WASHER14

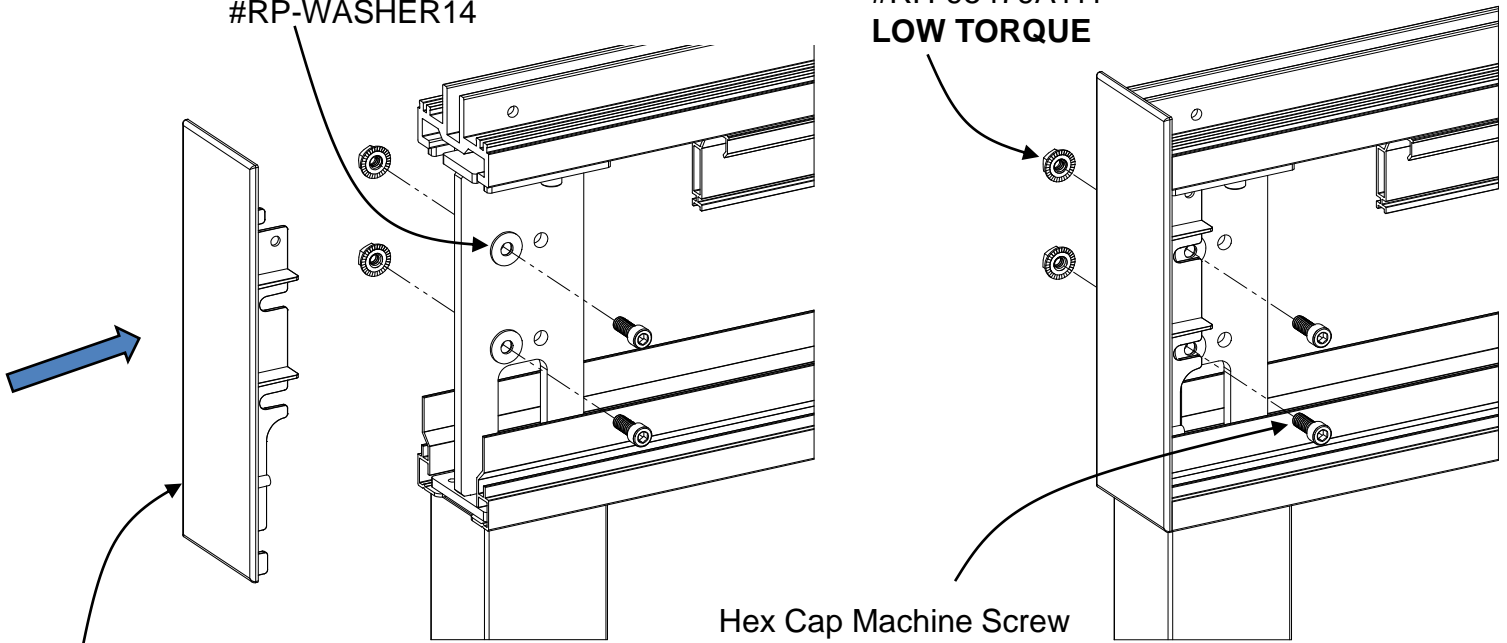

End Cap

Hex Cap Machine Screw  
1/4-20 x 5/8" long  
3/16" Hex Drive  
2 places  
#RH-91251A542

Step 9: Snap Beam Covers into place.

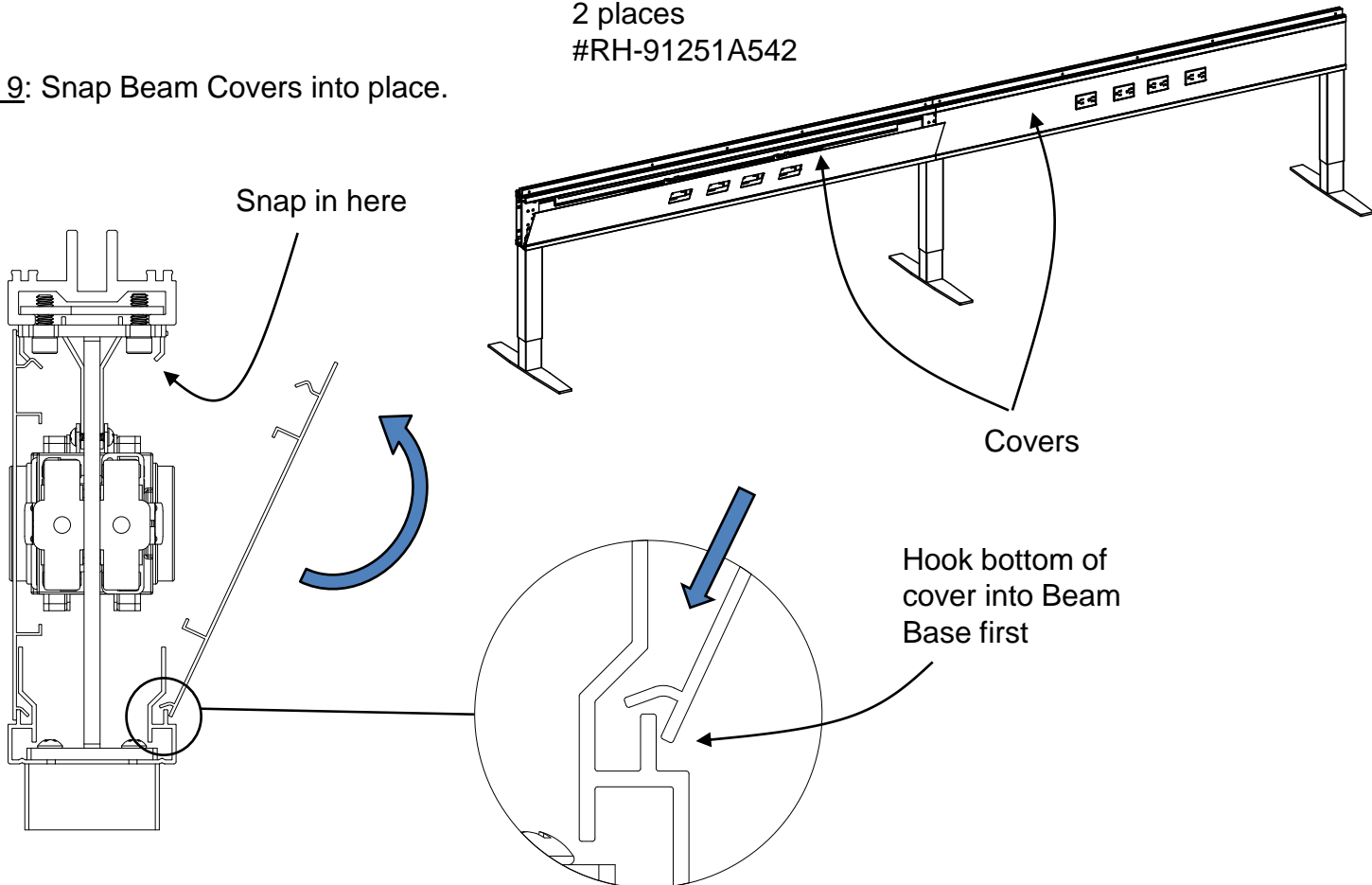

# Day to Day Power Beam

Step 10: Install top covers.

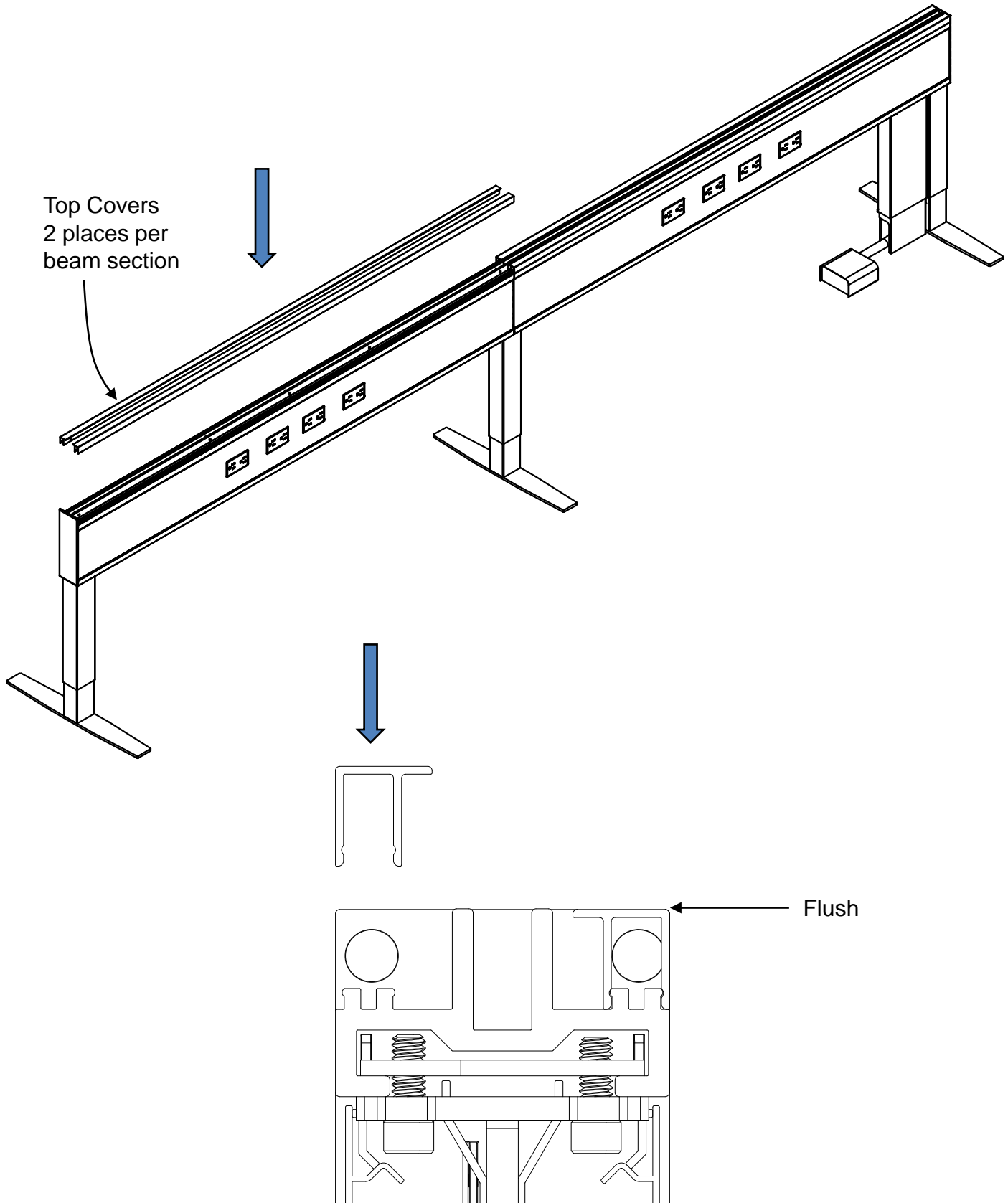

# Day to Day Power Beam

Step 11: Level Beam assembly.

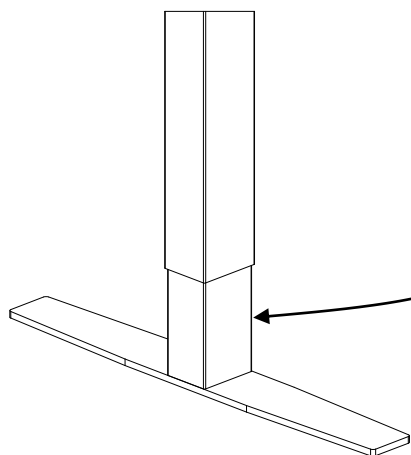

Lift Bottom Leg Cover to expose the 4 set screws and loosen

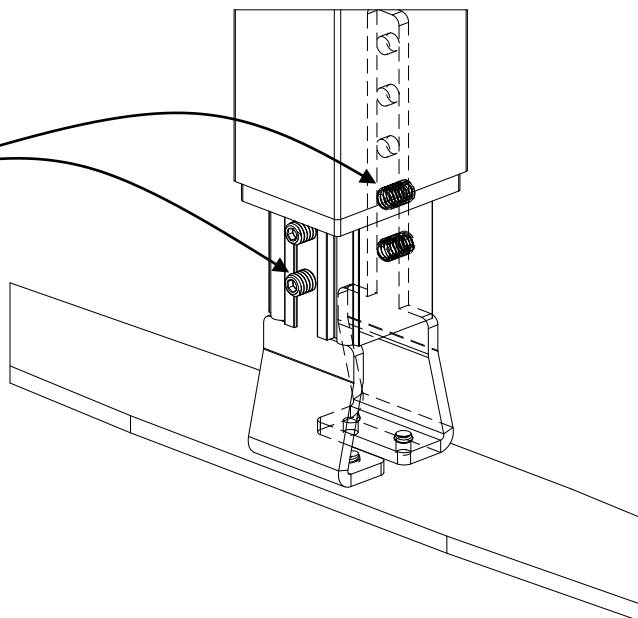

Extend leg to desired height

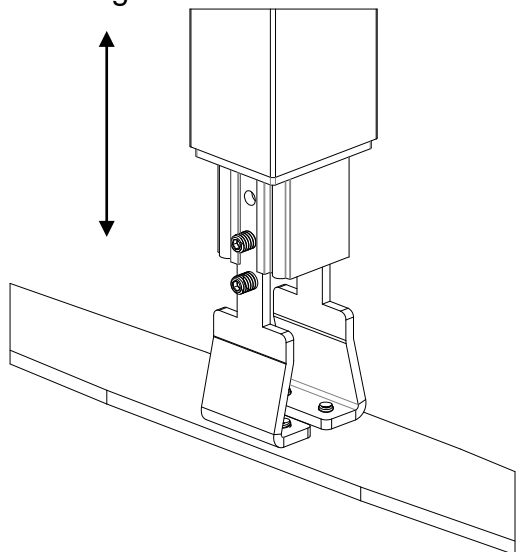

If required, move set screws up to new hole locations

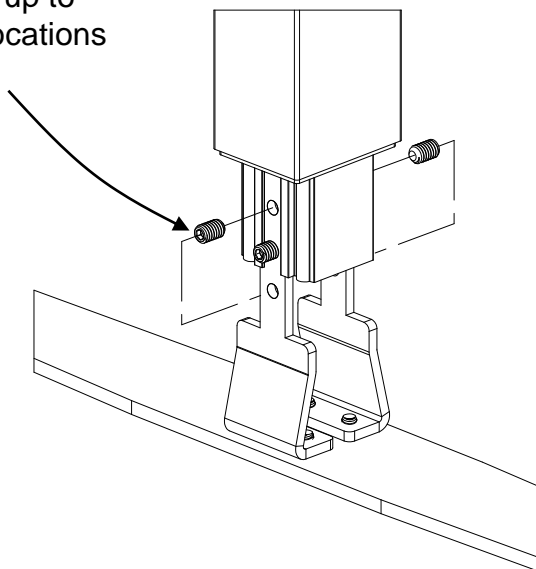

Level

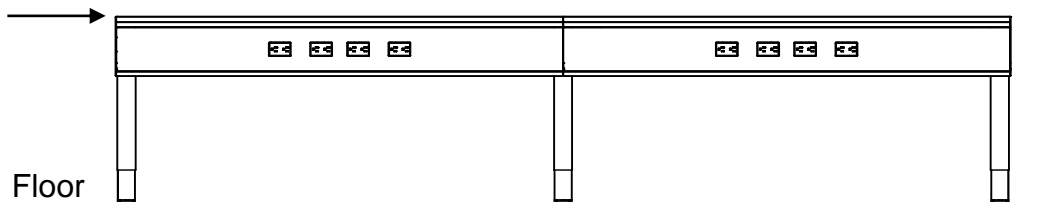

Floor

Level vertically and tighten set screws to lock in place

