



# HOLDEN PULL UP ASSEMBLY



1 PC



1 PC

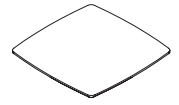

1 PC



A  
2 PCS



B  
4 PCS

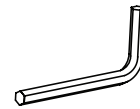

C  
1 PC



D  
2 PCS

## STEP 01

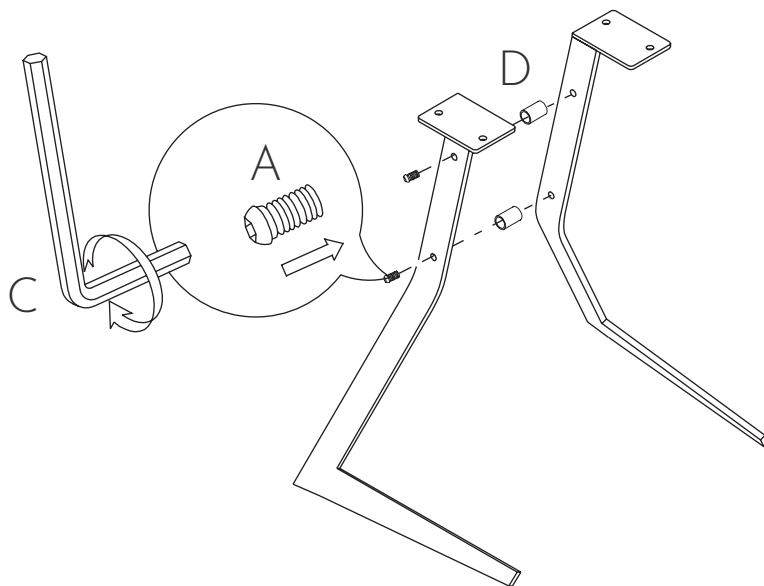



# HOLDEN PULL UP ASSEMBLY

---

STEP **02**

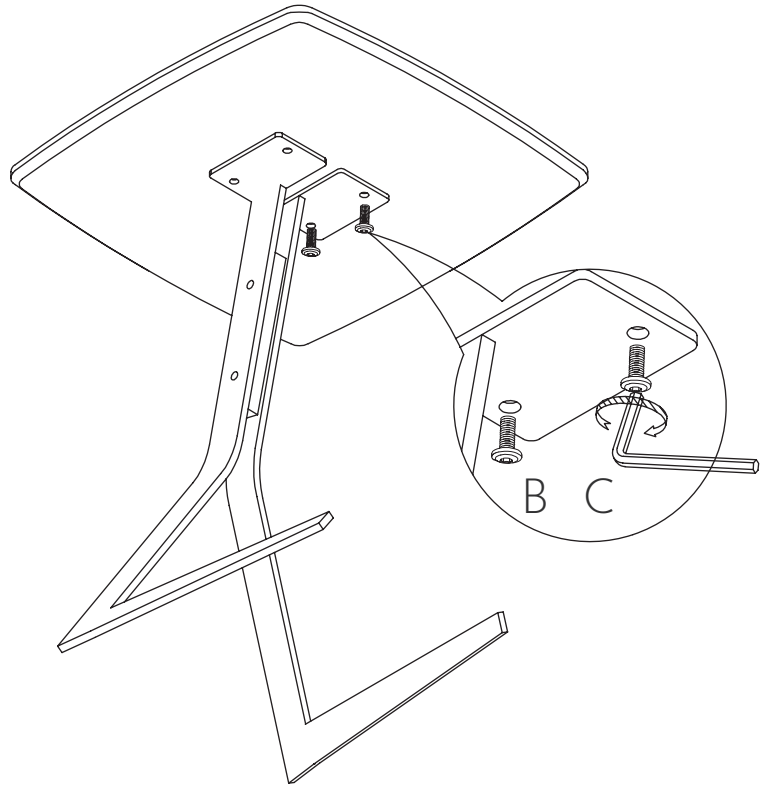



# HOLDEN RACETRACK ASSEMBLY

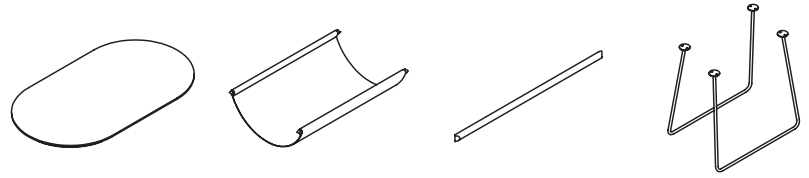

1 PC

1 PC

1 PC

1 PC

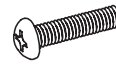

A  
6 PCS



B  
8 PCS

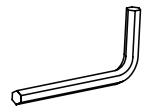

C  
1 PC

## STEP 01

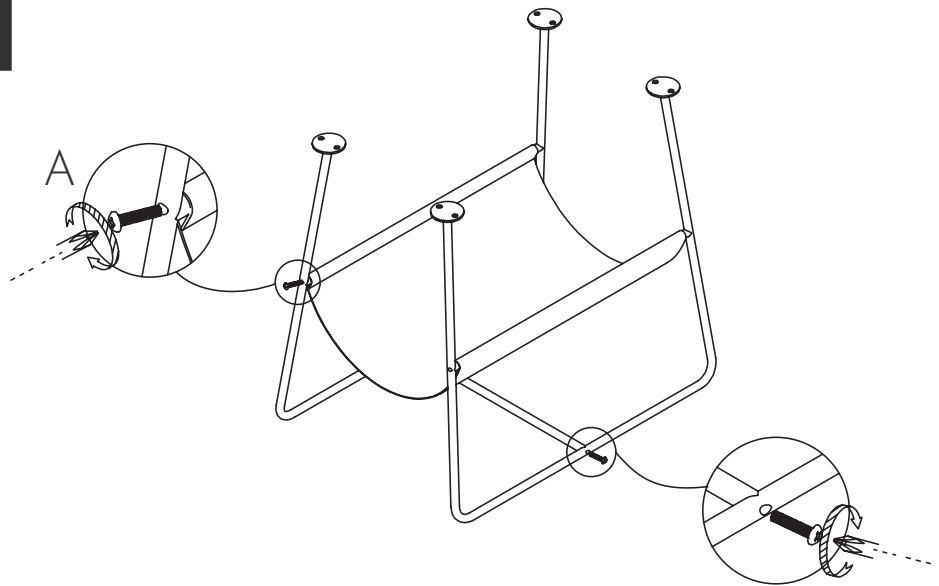



# HOLDEN RACETRACK ASSEMBLY

---

## STEP 02

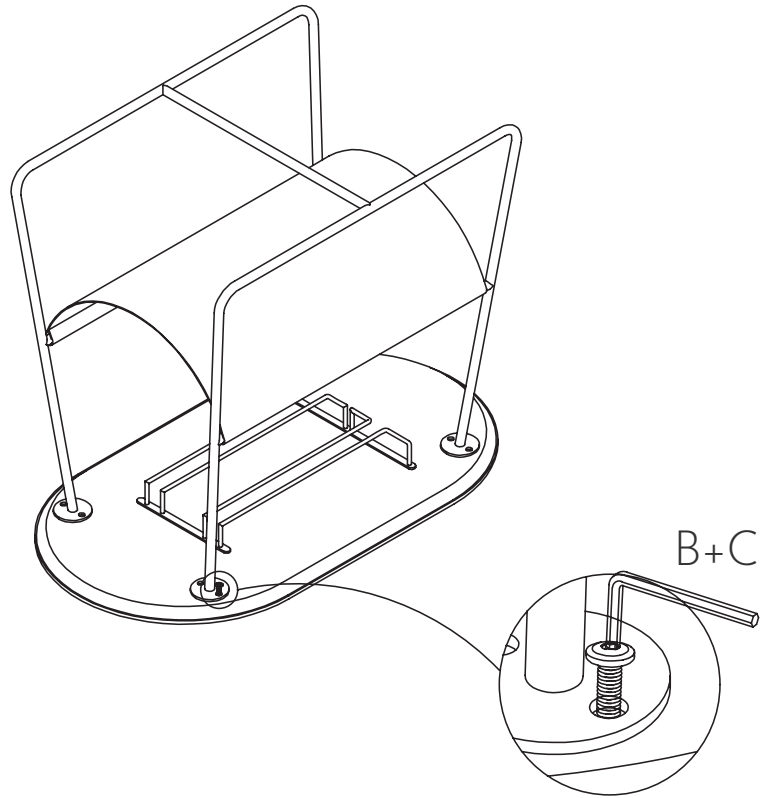



# HOLDEN ROUND ASSEMBLY

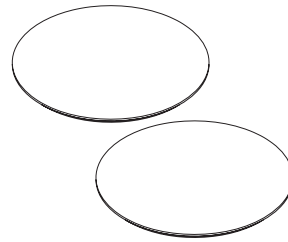

2 PCS

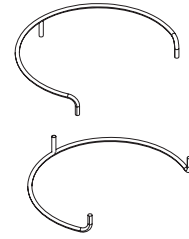

2 PCS

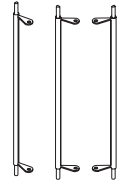

3 PCS



A  
12 PCS



B  
6 PCS

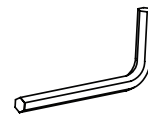

C  
1 PC

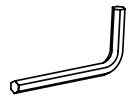

D  
1 PC

## STEP 01

PLACE TOP SUPPORT STRUCTURE ON TOP OF ALL THREE SUPPORT COLUMNS. ALIGN/PLACE ALL THREE SUPPORT COLUMNS INTO BOTTOM FOR BOTTOM SUPPORT STRUCTURE.

ATTACH LEGS TO SUPPORT STRUCTURE BY LOOSELY SECURING TWO (A) SCREWS AT TOP AND BOTTOM OF EACH LEG WITH (D) ALLEN KEY. REPEAT FOR EACH LEG.

**NOTE:** DO NOT TIGHTEN UNTIL LAST STEP

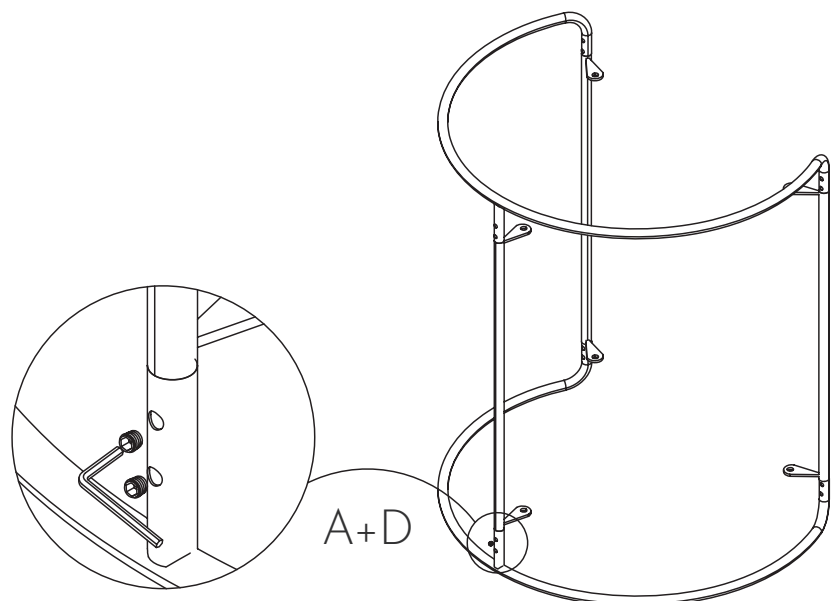

**STEP 02**

PLACE ONE TABLETOP ON SUPPORT BRACKET AND ALIGN WITH PRE-DRILLED HOLES. SECURE THE TABLETOP WITH THREE (B) SCREWS. REPEAT FOR SECOND TABLETOP.

TIGHTEN (A) SCREWS WITH (D) ALLEN KEY.

