



Kimball®

PRIORITY™



A MULTITUDE OF POSSIBILITIES

No matter where you work or how you work, Priority supports you in extensive ways. Wall-mounted overhead cabinets with writable glass fronts provide storage and function while wall-supported tiles with tackable surfaces, along with the accessory rail, hangs needed files and personal items off the workspace. Complete the solution with a simple pedestal height-adjustable desk that supports modern day work environments.

Also shown
Task Chair: **Helio** / Ottomans: **Joelle**



FEATURES WITH BENEFITS

The workspace needs options and Priority offers plenty of them. Integrate vertical storage with open frame shelves along with low storage on metal bases to create a space with a beautiful aesthetic. Complete the configuration with a height-adjustable L-shaped desk that offers plenty of work space and the added benefit of being able to go from sitting to standing throughout the day.

Also shown
Task Chair: **Joya**



BETTER TOGETHER

Whether it's a modern-day, stand-alone desk or an in-line, height-adjustable credenza, Priority integrates elements to create a truly comprehensive solution that supports executive, community and home offices.

Also shown
Task Chair: **Nate & Natty** / Table: **KORE**



MODERN MEETS EXECUTIVE

With Priority height-adjustable desk, you can rise (or lower) to the occasion. Now the private office can have the same flexibility and function with a modern-day aesthetic, bringing a timeless appeal to the executive space.

THOUGHT STARTERS

Designed For Change

Change happens, and not always according to plan. That's why Priority provides what a workplace needs: the ability to reconfigure, rescale, and re-adapt to suit virtually any situation. With plenty of storage options, Priority is designed not only for the task at hand, but for the continuity of an entire organization.



Sit or Stand

You pick the way you want to work. Seated at a desk or standing at a height-adjustable surface. Lighter in scale with plenty of closed storage options.



Infinitely Flexible

What you see is just the beginning. Priority can be a desk, shared workspace, or collaborative area. A multitude of styles and options offers more than a place to work—it offers a place to work your way.



Independent Style

Pullout drawers and writable doors compose the backdrop of this work environment—complete with a height-adjustable freestanding desk and paper storage below each overhead storage door.

Surround Yourself

What every employee needs—plenty of storage and surface space to spread out.



Maximize Space

Longer length metal bases have only a single center leg for an uncommonly clean design.

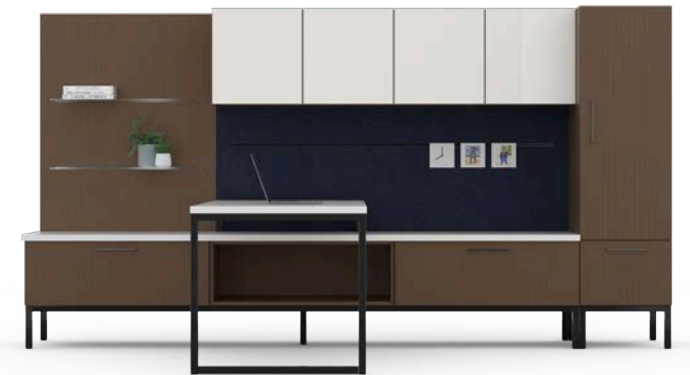



PRIORITY™



Please make an appointment to visit us at:
3401 Madison Street Skokie, IL 60076
www.appliedergonomics.com

Call us: (847) 679-5148
Toll-free: (844) 859-9247
Fax: (847) 933-0018

Email the President directly
jmeltzer@appliedergonomics.com