



Kimball®

WORK|ABLE™  
Designed by Brian Graham



# WORK|ABLE

Designed by Brian Graham

There are a lot less walls in the workplace today. With teams and workloads continuing to grow, we're being challenged to maximize every inch of space. Now, more than ever, the walls and surfaces need to do more "to earn their place".

San Francisco designer, Brian Graham, partnered with Kimball to create a solution that leverages the wall and makes it as functional as it can be.

"I am very excited about Work|Able being applied in so many different scenarios," Graham explained.

"With the increasing importance of open-plan environments, Work|Able provides the opportunity to take a wall or space that once wasn't utilized and give it purpose."

With a modern approach to utilize the wall in its entirety, Work|Able was designed as a forward-thinking solution with increased features that easily integrate with technology. As real estate continues to shrink, smaller enclaves and tight spaces are becoming incredibly valuable.

"I wanted to create something that a designer can tailor to a specific look,



a specific customer need. I want them to think of it as a kit-of-parts that can be used over and over on different projects by dialing the look and the feel up or down depending on what the expression is," Graham added.

Work|Able reflects a broader array of visual expressions. Materials like

"With the increasing importance of open-plan environments, Work|Able provides the opportunity to take a wall or space that once wasn't utilized and give it purpose."

pegboard, chalkboard, cork, and PET are paired with unique work tools, accessories and work surfaces to create an aesthetic that is simple and honest, yet effective and progressive.

This type of flexibility, combined with the honest design of Work|Able, delivers a fully functional solution that integrates seamlessly into any space.

"From something as intimate as making the space between your work surface and your overhead more functional, to allowing your opposite wall to grow in scale. The possibilities are endless with this solution," Graham concluded.



## ENDLESS POSSIBILITIES

Incorporate workstations into the wall by hanging surfaces off of the Work|Able Traxx at low, standing or work surface height. Add work tools, shelves and accessories to support everyday work. Acoustic softness combined with a personal level of materiality, tactile and differentiation creates an engaging application within the larger environment.

*Also shown*  
Task Seating: **Helio** / Table Base: **Xsede Height Adjust**



## MODERN MAXIMIZATION

Work|Able allows free, off-module placement of tiles, work surfaces, storage, and accessories wherever you need them. Integrate different panel sizes and materials such as chalkboard, pegboard, cork and acoustical PET tiles. Facilitate collaboration by hanging a TV off the Traxx. Work|Able livens up any space while providing flexibility and functionality.

*Also shown*  
Task Seating: Nate & Natty / Ottomans: fiXt



## CREATIVE COLLABORATION

With thoughtful design details Work|Able maximizes touchdown, group, and meeting space, leveraging the wall to make it accessible and interactive. New tools and accessories facilitate collaboration. Work|Able inspires creativity on the wall with a simple design that is uniquely modern and easy to integrate.

Also shown  
Task Seating: **Joya** / Table: **KORE**

# STATEMENT OF LINE

Please reference the price list for full statement of line and material options.

## TILES *Please reference the price list for additional Tiles.*



Acoustical PET

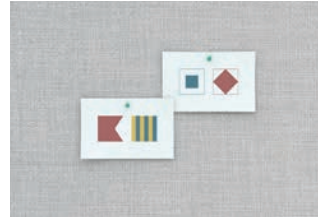

Fabric



Slat



Markerboard / Magnetic

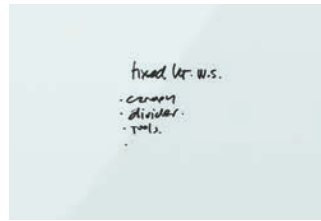

Back-Painted Glass

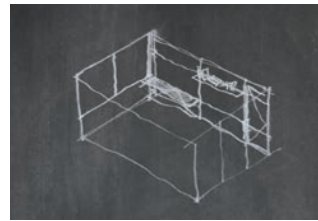

Chalkboard Tile



Cork

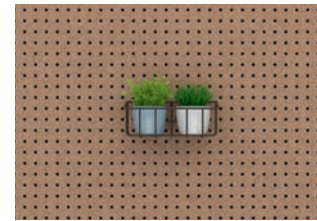

Pegboard Tile

## WORKSURFACES



Rectangular



Rectangular with Soft-Radius Corners



Asymmetric with Soft-Radius Corners

## WORKSURFACE SUPPORTS



Wood



Painted Metal



Clearcoat on Metal



Rectangular with Soft-Radius Corners with Softened Vinyl Rim



Butcher Block with Bull Nose Edge



Plywood

## RIMS *Please reference the price list for additional Rims.*

## NARRATE® WORK TOOLS *Please reference the Narrate price list for additional Narrate Work Tools.*



Metal Work Tools: Picture Frame



Metal Work Tools: Phone/Ear Bud Holder



Plastic Work Tools: Accessory Tray



Plastic Work Tools: Pencil Cup

## ACCESSORY SHELVES *Please reference the price list for additional Shelves.*



4" Round Shelf



6" Oval Shelf

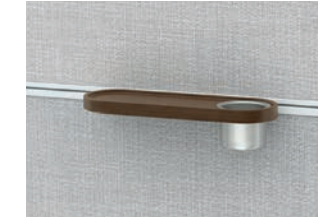

12" Oval Shelf with Utility Cup

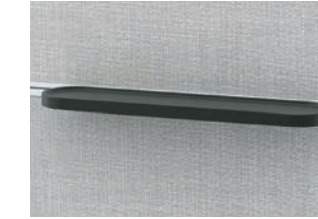

18" Oval Shelf



6" Shelf with Planter



9" x 24" Shelf



12" x 24" Shelf

## PEGBOARD ACCESSORIES *Please reference the price list for additional Pegboard Accessories.*

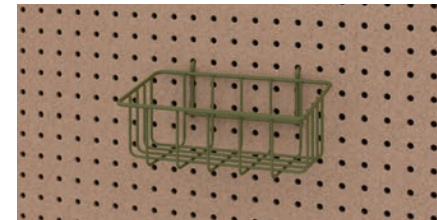

Small Basket

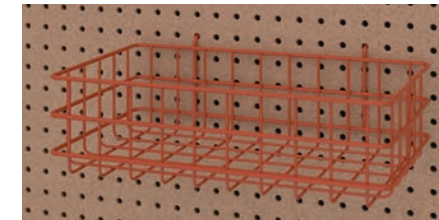

Large Basket

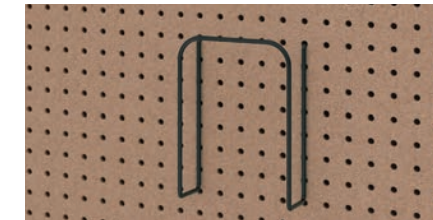

Vertical File Holder



Plastic Jar

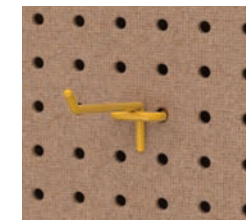

Single Hook

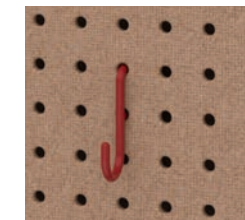

J Hook

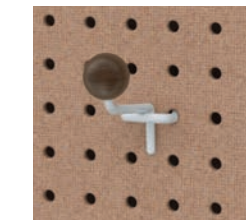

Coat Hook

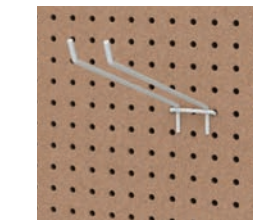

11" Double Hook

## ACCESSORIES



Markerboard/Flip Chart Holder

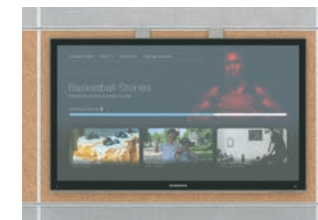

Traxx-Mount TV Bracket



Wire Manager



Perks® Power/USB Module with 6' Cord



# WORK|ABLE™

Designed by Brian Graham



Please make an appointment to visit us at:  
3401 Madison Street Skokie, IL 60076  
[www.appliedergonomics.com](http://www.appliedergonomics.com)

Call us: (847) 679-5148  
Toll-free: (844) 859-9247  
Fax: (847) 933-0018

Email the President directly  
[jmeltzer@appliedergonomics.com](mailto:jmeltzer@appliedergonomics.com)