



Kimball®

PRIORITY™





## A MULTITUDE OF POSSIBILITIES

No matter where you work or how you work, Priority supports you in extensive ways. Wall-mounted overhead cabinets with writable glass fronts provide storage and function while wall-supported tiles with tackable surfaces, along with the accessory rail, hangs needed files and personal items off the workspace. Complete the solution with a simple pedestal height-adjustable desk that supports modern day work environments.

Also shown  
Task Chair: **Helio** / Ottomans: **Joelle**





## FEATURES WITH BENEFITS

The workspace needs options and Priority offers plenty of them. Integrate vertical storage with open frame shelves along with low storage on metal bases to create a space with a beautiful aesthetic. Complete the configuration with a height-adjustable L-shaped desk that offers plenty of work space and the added benefit of being able to go from sitting to standing throughout the day.

Also shown  
Task Chair: **Joya**





## BETTER TOGETHER

Whether it's a modern-day, stand-alone desk or an in-line, height-adjustable credenza, Priority integrates elements to create a truly comprehensive solution that supports executive, community and home offices.

Also shown  
Task Chair: **Nate & Natty** / Table: **KORE**





## MODERN MEETS EXECUTIVE

With Priority height-adjustable desk, you can rise (or lower) to the occasion. Now the private office can have the same flexibility and function with a modern-day aesthetic, bringing a timeless appeal to the executive space.

# THOUGHT STARTERS

## Designed For Change

Change happens, and not always according to plan. That's why Priority provides what a workplace needs: the ability to reconfigure, rescale, and re-adapt to suit virtually any situation. With plenty of storage options, Priority is designed not only for the task at hand, but for the continuity of an entire organization.



## Sit or Stand

You pick the way you want to work. Seated at a desk or standing at a height-adjustable surface. Lighter in scale with plenty of closed storage options.



## Infinitely Flexible

What you see is just the beginning. Priority can be a desk, shared workspace, or collaborative area. A multitude of styles and options offers more than a place to work—it offers a place to work your way.



## Independent Style

Pullout drawers and writable doors compose the backdrop of this work environment—complete with a height-adjustable freestanding desk and paper storage below each overhead storage door.

## Surround Yourself

What every employee needs—plenty of storage and surface space to spread out.



## Maximize Space

Longer length metal bases have only a single center leg for an uncommonly clean design.

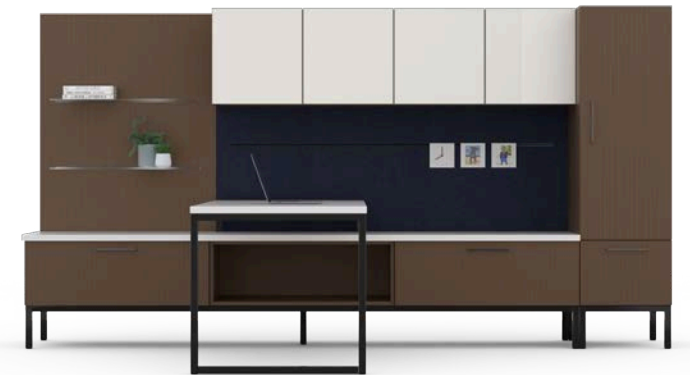





# PRIORITY™



Please make an appointment to visit us at:  
3401 Madison Street  
Skokie, IL 60076  
[www.appliedergonomics.com](http://www.appliedergonomics.com)

Call us: (847) 679-5148  
Toll-free: (844) 859-9247  
Fax: (847) 933-0018

Email the President directly  
[jmeltzer@appliedergonomics.com](mailto:jmeltzer@appliedergonomics.com)